

Features

All bronze construction
Corrosion resistant
Straight stream to fog
Changeable flow rate
Easy to maintain and clean

Description

Uller nozzles are especially designed for Siv monitors or any other monitor with 2½" water outlet. The nozzles are suitable for water and foam solutions. They are manufactured in rugged brass.

The discharge pattern is adjustable from fog to straight stream during operation. Flow rate can be changed in between use.

Application

Ideal to use in connection with portable or fixed monitors due to their remarkable strengths and adjustable discharge pattern.

Recommended foam concentrates

The Uller-models can be used with all types of foam, such as: [High quality fire fighting foams - Fomtec](#)

Operation

The Uller nozzles are fitted with a 2½" female thread, suitable for Siv monitor or any other monitor with 2½" water outlet. After using foam solution, clean it with water. By turning the handles, the discharge pattern can be adjusted from straight stream to fog. Flow will remain the same regardless of spray pattern.

Optional

- Other NST inlet thread
- Light alloy
- Self-inducting version

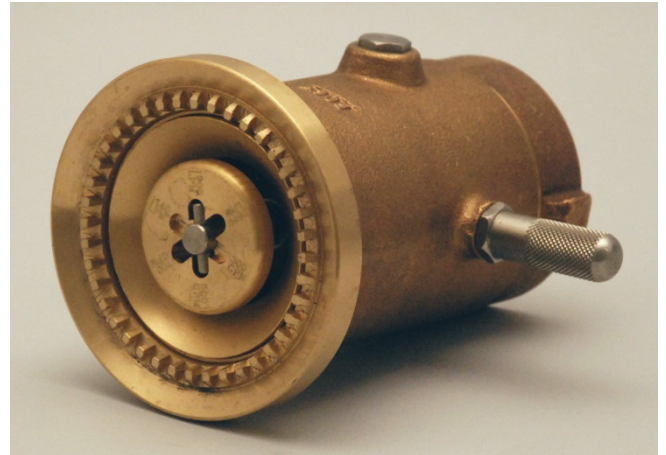

Technical data

Flow rate	1140 / 1900 / 2660 lpm
Nominal inlet pressure	7 bar
Inlet	2 ½" BSP FM (standard)
Material	Bronze
Length	185 mm
Weight	7 kg
Part no.	20-3601-19

Nozzle Pressure	Flow Setting	Actual Flow	Straight Stream Reach with water	
			Effective	Overall
BAR	LPM	LPM	Meters	
5	1140	985	45	48
	1900	1645	53	56
	2660	2290	55	58
7	1140	1140	51	54
	1900	1900	60	64
	2660	2660	62	65
8.5	1140	1265	58	60
	1900	2120	67	70
	2660	2970	67	70

Note: under an angle of 32 degr.

Dimensions & parts list

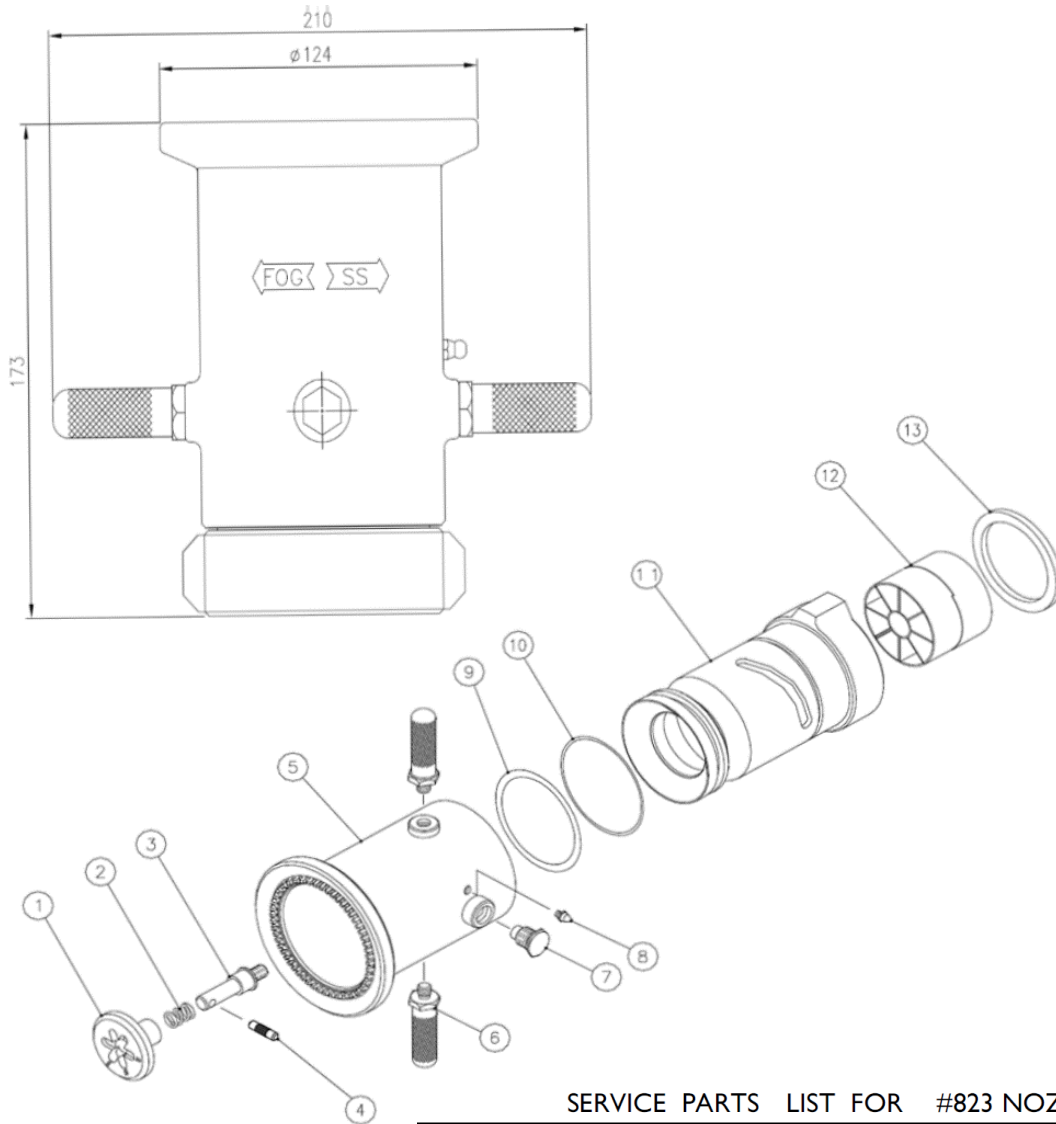

SERVICE PARTS LIST FOR #823 NOZZLE

ITEM NO.	DESCRIPTION	PARTS NO .	MATERIAL	QUANTITY	
				823	823-BC
1	BAFFLE HEAD	A0331	ALUMINUM	1	
		B0331	BRONZE		1
2	SPRING	F0196	304 S.S.	1	1
3	STEM	F0215	BRONZE	1	1
4	PIN(Ø6*24L)	F0150	BRONZE	1	1
5	NOZZLE BODY	A0320	ALUMINUM	1	
		B0321	BRONZE		1
6	HANDLE	F0214	303 S.S.	2	2
7	SCREW(9/6"-18UNF)	S0101	304 S.S.	1	1
*8	GREASE FITTING	F0201	BRONZE	1	1
*9	O-RING(P-70)	O0140	EPDM	1	1
*10	O-RING(G-75)	O0350	EPDM	1	1
11	SLEEVE	A0310	ALUMINUM	1	
		B0314	BRONZE		1
12	STREAM SHAPER	D0140	PLASTIC	2	2
*13	GASKET(80*64*5)	D0071	EPDM	1	1

8" indicates that the parts included in service kit No.1822,1822-BC

2016.01.28